

2 Ports 10/100M Industrial PoE Fiber Switch

1*E POE+1*EF Industrial PoE Switch

EWIND



- 1*10/100M PoE port+ 1*155M SC slot port Industrial PoE Switch, port 1 support IEEE 802.3af/at;
- PoE port support AF/AT intelligent recognition. Standard power is 15.4W/port, Maximum power: 30W/port;
- PoE default: 1, 2(+)/3, 6(-), alternative: 4, 5(+)/7, 8(-);
- Switching capacity:1.6Gbps, MAC table:1K;
- Input voltage: DC48-57V, Redundant dual power 5-bit industrial terminals;
- IP protection level: IP40; Rail-type installation;
- 5 years warranty.

RoHS **FC** **CE**

Introduction

The EW-PIS1702-1FE is a 10/100M industrial PoE fiber switch. It has 1*10/100M PoE port and 1*155M SC slot port, Port 1 can support IEEE 802.3af/at PoE standard, single port PoE power up to 30W, the maximum PoE output power is 18W (at-36W). As a PoE power supply device, it can automatically detect and recognize the power receiving equipment that meets the standard and supply power through the network cable. It can supply power to POE terminal equipment such as wireless AP, web camera, VoIP phone, industrial sensor through network cable, and meet the network environment that needs high-density PoE power supply. It is suitable for intelligent transportation, rail transit, electric power, mining, metallurgy and green energy. Industrial scenes such as construction set up a cost-effective and stable communication network. Unmanaged model, plug and play, no configuration, easy to use.

TECHNICAL SPECIFICATION

Model	EW-PIS1702-1FE
Fixed Port	1*10/100Base-TX PoE port (Data/Power) 1*155M uplink SC port (Data) 2 set of V+, V- redundant DC power interface (5 Pin Phoenix terminal)

Twisted Pair Transmission	10BASE-T: Cat3,4,5 UTP (≤ 100 meter) 100BASE-T: Cat5e or later UTP (≤ 100 meter)
Ethernet Port	10/100Base-TX, auto-sensing, Full/half duplex MDI/MDI-X self-adaption
SFP Slot Port	The default optical module is single-mode dual-fiber 20km, SC interface.
Optical Cable/ Distance	Multi-mode: 850nm 0~500M; 1310nm 0~2kM; single mode: 1310nm 0~40KM,1550nm 0-120KM.
Network Protocol	IEEE802.3 10BASE-T, IEEE802.3i 10Base-T, IEEE802.3u 100Base-TX, IEEE802.3u 100Base-FX, IEEE802.3x
Forwarding Mode	Store and Forward (Full Wire Speed)
Switching Capacity	1.6Gbps
Forwarding Rate@64byte	0.30Mpps
MAC	1K
Buffer Memory	768K
Jumbo Frame	1536bytes
LED Indicator	Power: PWR (green), Network: Link (yellow), Fiber port: L/A (green) , PoE: PoE (green)
PoE Port	Port 1
Power Supply Pin	Default 1/2 (+), 3/6 (-), optional 4/5 (+), 7/8 (-)
Max Power Per Port	30W; IEEE802.3af/at
Total PWR / Input Voltage	36W /48VDC
Power Consumption	Standby:<4W; Full load:<36W
Working Voltage	48-57VDC; 5 Pin industrial Phoenix terminal, support anti-reverse protection.
Power Supply	No, optional 48V/24W or 48V/36W industrial power supply
Operation TEMP / Humidity	-40~+75°C;5%~90% RH Non condensing
Storage TEMP / Humidity	-40~+85°C;5%~95% RH Non condensing
Dimension (L*W*H)	119*100*30mm
Net /Gross Weight	<0.2 kg / <0.5 kg
Installation	Desktop, DIN rail

Lightning protection / protection level	<p>Lightning protection: 6KV 8/20us; Protection level: IP40</p> <p>IEC61000-4-2(ESD): ±8kV contact discharge, ±15kV air discharge</p> <p>IEC61000-4-3(RS):10V/m(80~1000MHz)</p> <p>IEC61000-4-4(EFT): power cable: ±4kV; data cable: ±2kV</p> <p>IEC61000-4-5(Surge): power cable:CM±4kV/DM±2kV; data cable: ±4kV</p> <p>IEC61000-4-6(radio frequency transmission):10V(150kHz~80MHz)</p> <p>IEC61000-4-8(power frequency magnetic field):100A/m;1000A/m ,1s to 3s</p> <p>IEC61000-4-9(pulsed magnet field):1000A/m</p> <p>IEC61000-4-10(damped oscillation):30A/m 1MHz</p> <p>IEC61000-4-12/18(shockwave):CM 2.5kV, DM 1kV</p> <p>IEC61000-4-16(common-mode transmission):30V; 300V,1s</p> <p>FCC Part 15/CISPR22(EN55022): Class A</p> <p>IEC61000-6-2(Common Industrial Standard)</p>
Mechanical Properties	<p>IEC60068-2-6 (anti vibration)</p> <p>IEC60068-2-27 (anti shock)</p> <p>IEC60068-2-32 (free fall)</p>
Certification	CCC; CE mark, commercial; CE/LVD EN60950; FCC Part 15 Class B; RoHS;
Warranty	5 years, lifelong maintenance.

DIMENSION

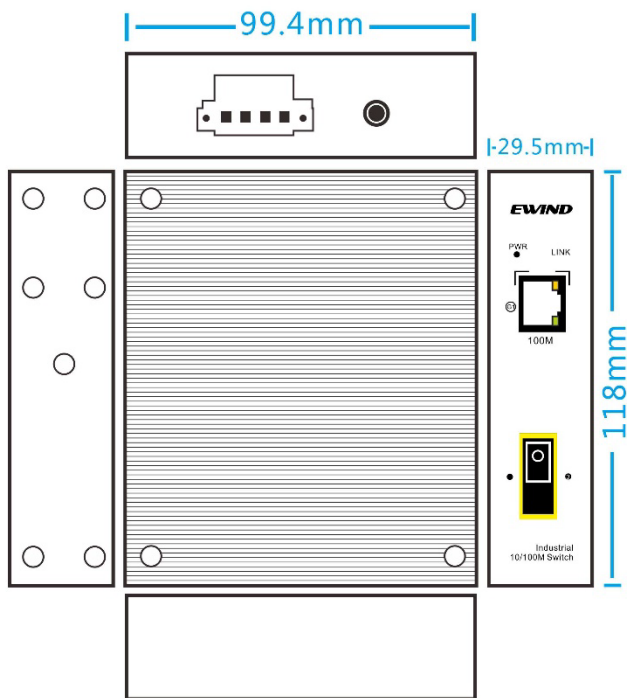

APPLICATION

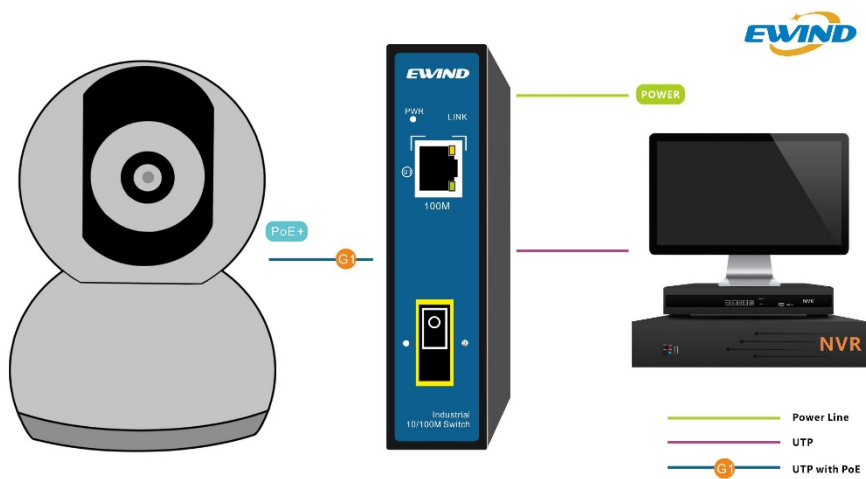

ORDER INFORMATION

Model	Description	Matched Power Supply
EW-PIS1702-1FE	Unmanaged industrial PoE fiber switch with 1*10/100M PoE port and 1*155M SC port, Port 1 can support PoE IEEE802.3af/at. By default, the SC port 1310nm/20km single-mode dual-fiber module. It can support dual DC redundant power input (Phoenix terminal connection) and DIN rail mounting.	60W
EW-PIS1702-1FE-M	Unmanaged industrial PoE fiber switch with 1*10/100M PoE port and 1*155M SC port, Port 1 can support PoE IEEE802.3af/at. By default, the SC port 850nm/0.5km or 1310nm/2km multi-mode dual fiber module. It can support dual DC redundant power input (Phoenix terminal connection) and DIN rail mounting.	60W
EW-PIS1702-1FE-A	Unmanaged industrial PoE fiber switch with 1*10/100M PoE port and 1*155M uplink SC port. Port 1 can support IEEE 802.3af/at. By default, the SC port 1310nm/20km single-mode single-fiber module. It can support dual DC redundant power input (Phoenix terminal connection) and DIN rail mounting.	60W
EW-PIS1702-1FE-B	Unmanaged industrial PoE fiber switch with 1*10/100M PoE port and 1*155M uplink SC port. Port 1 can support IEEE 802.3af/at. By default, the SC port 1550nm/20km single-mode single-fiber module. It can support dual DC redundant power input (Phoenix terminal connection) and DIN rail mounting.	60W
Note: Industrial PoE switch does not include the power supply.		

PACKING LIST

CONTENT	QTY	UNIT
2 Ports 10/100M Industrial PoE Fiber Switch (EW-PIS1702-1FE)	1	SET
User Guide	1	PC
Warranty Card	1	PC